

**HARDWOOD LAKE
OGEMAW COUNTY, MICHIGAN
TREATMENT MAP
SURVEYED JUNE 19, 2023**

□ = 1 ACRE

Treatment

 Flumioxazin @ 100ppb + Aquathol-K @ 1 gal/acre (mixed beds) = 6.5 acres

Algae treatment up to 22.5 acres as permitted

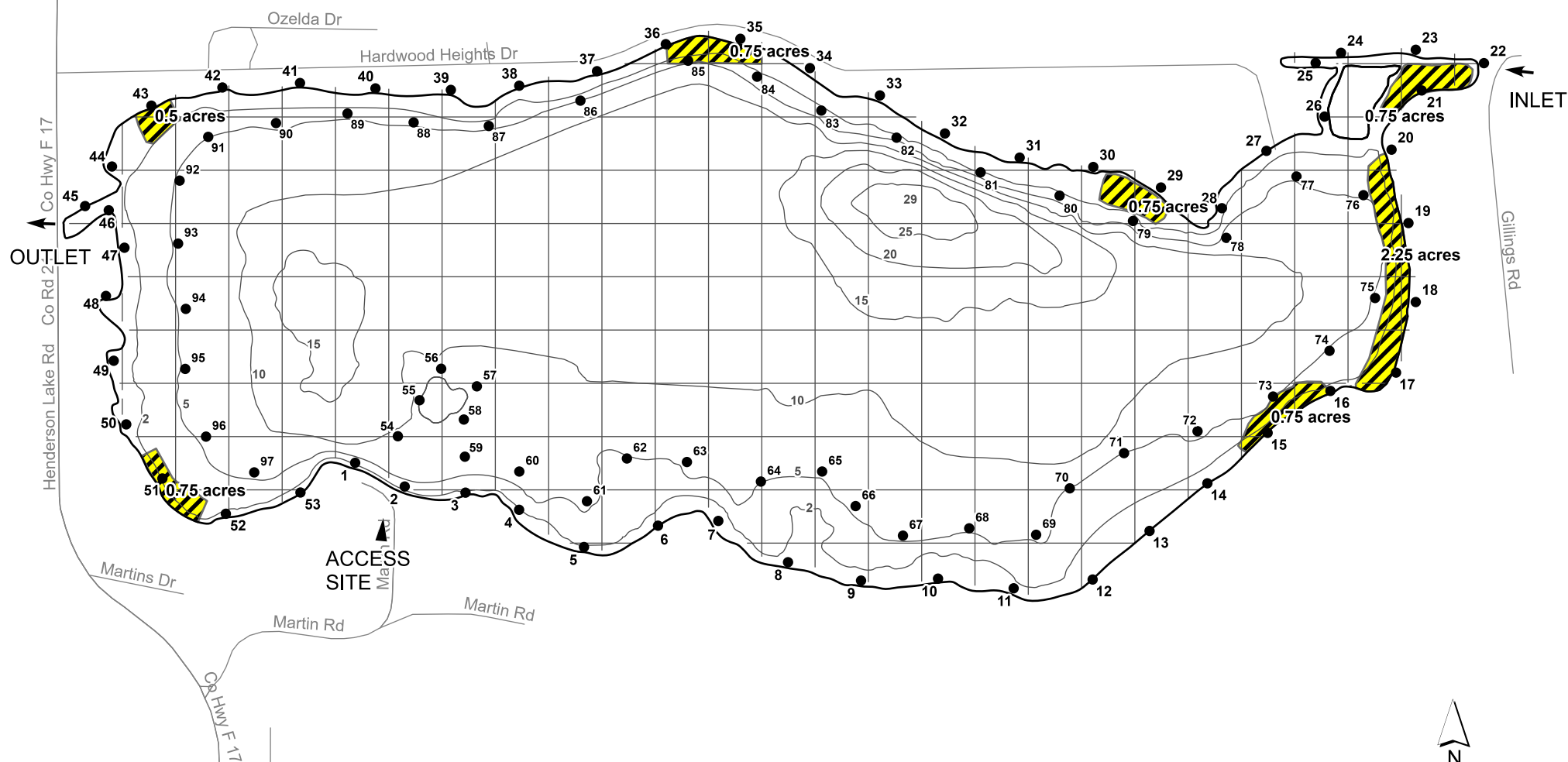

TOTAL LAKE AREA = 182 ACRES
REVISION DATE: JANUARY 2021
DEPTH CONTOUR SOURCE - BIOBASE 2020 - PROGRESSIVE AE

0 340 680 Feet
progressive|ae

EGLE Approved Treatment Map for 2022 – 2025 Map 1 of 2

Do not treat within 300 feet of the outlet.

Estimate of surface area of 0-10 foot contour = 102.5 ac
25 percent of surface area of 0-10 foot contour = 25.6 ac

