

HARDWOOD LAKE OGEMAW COUNTY, MICHIGAN MAY 18, 2022 TREATMENT MAP

□ = 1 ACRE

Treatment

Procellacor @ 6PDU/acre + Diquat @ 1 gal/acre (milfoil) = 8.5 acres

Developed shoreline algae treatment up to the permitted 24.75 acres

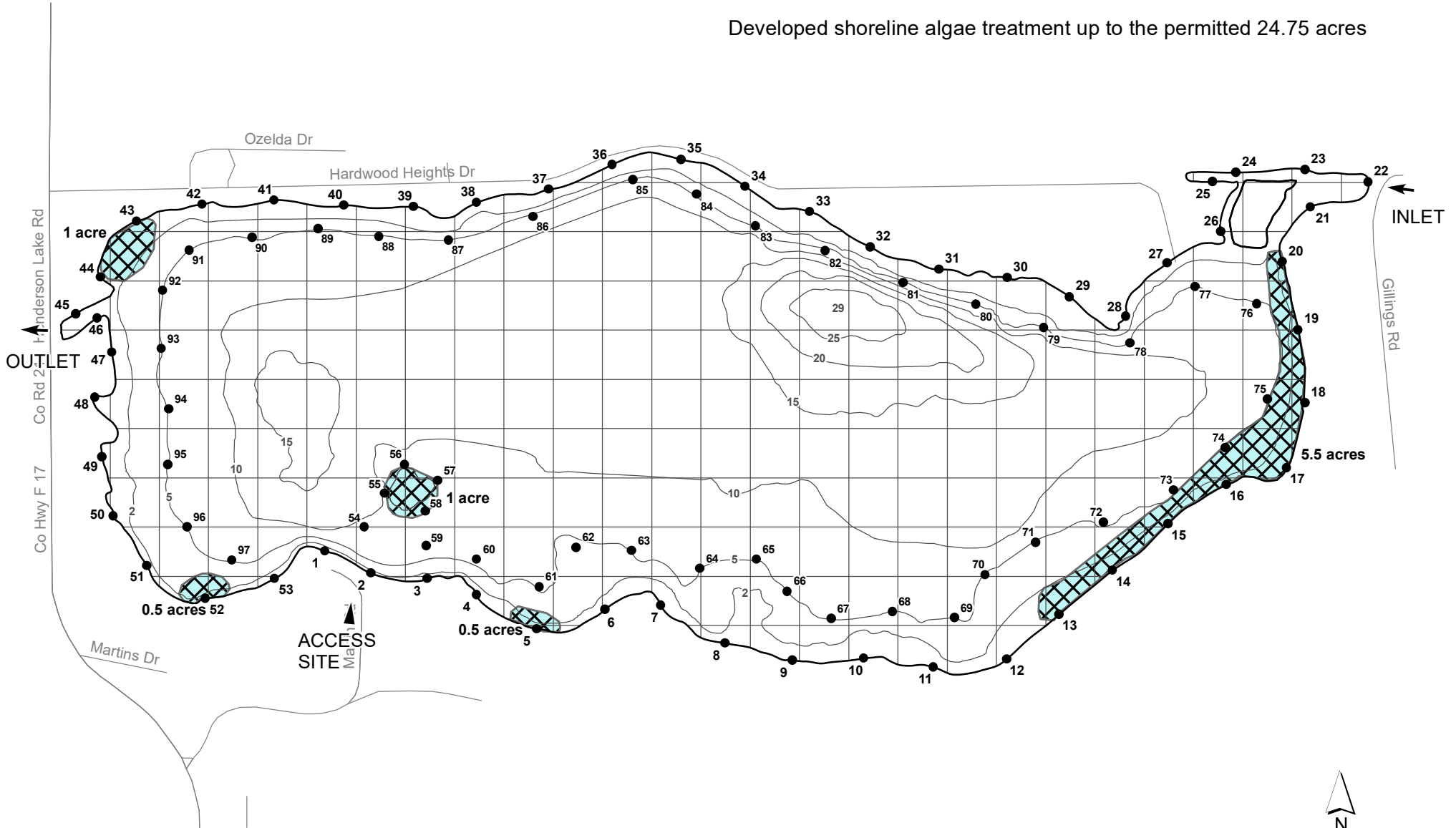

TOTAL LAKE AREA = 182 ACRES
 REVISION DATE: JANUARY 2021
 DEPTH CONTOUR SOURCE - BIOBASE 2020 - PROGRESSIVE AE